

# Product Data Sheet Type: PR23

Group: HEATSINKS Extrusions

For Clip + screw-on

Width : 29 mm  
 Height : 12 mm  
 Base height : 3 mm

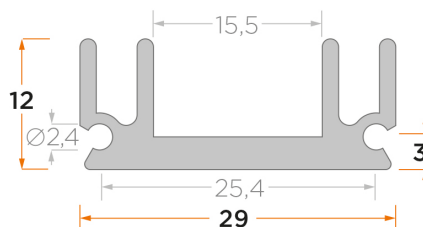

Extruded heat sink profile with counter-sunk mounting area

Surface: AL= Untreated aluminium, SE= anodised black, NE= anodised colourless, CR Chromated- colourless (Chrom6-free, RoHS conform)

Alloy: AlMgSi 0,5 F22

Standard tolerances (if not otherwise required):

Extrusion tolerances for aluminium profiles: DIN 1748 – section 4 and DIN 17615 – section 3 respectively. DIN ISO 755 – 9 and DIN ISO 12020 – 2 respectively.

Machining tolerance: DIN 2768 m

Finishing to your specification

Length, milling, surface refinement, including mounting-, insulation-, thermal interface accessories

Additional information:

Measurement conditions for the values in the thermal diagram are described at '[www.alutronic.com/service/thermal-measurments](http://www.alutronic.com/service/thermal-measurments)'

General information for designing your heat sink solution you will find at '[www.alutronic.com/service/technical-information](http://www.alutronic.com/service/technical-information)'

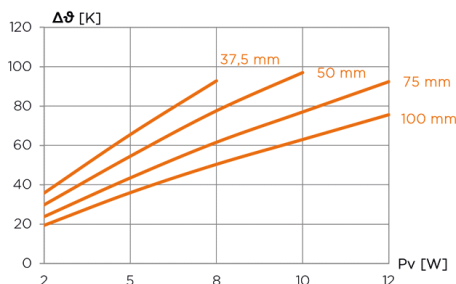
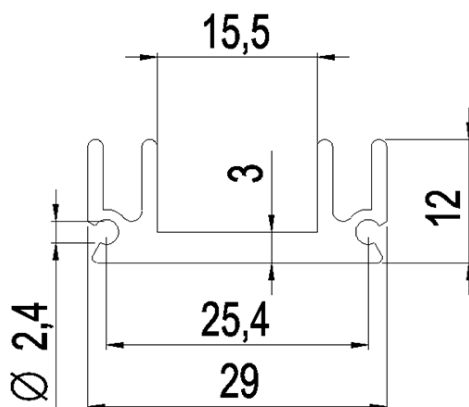

Pv [W]	RthK [K/W]			
2	17,9	14,9	11,9	9,7
5	13,1	10,9	8,7	7,2
8	11,6	9,7	7,7	6,3
10		9,7	7,7	6,3
12			7,7	6,3
mm	37,5	50	75	100
kg/m	0,40			